



Traktorski lanci i elementi za izvlačenje

*Tractor Chains and
Drawing Elements*



LANAC KRPAN GT

CHAIN GT

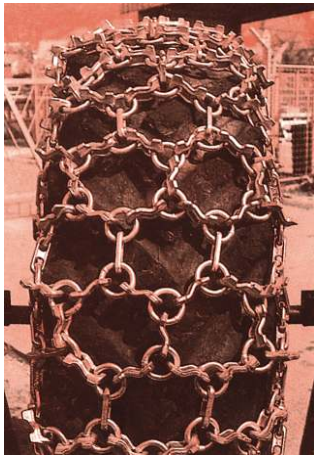

LANAC KRPAN GS

CHAIN GS



dimenzije gume tire size	GS 11	GT 11	GS 14	GT 14	dimenzije gume tire size	GS 11	GT 11	GS 14	GT 14
9,5/9 x 24	●	●			14,9/13 x 28	●	●		
11,2/10 x 24	●	●			16,9/14 x 28	●	●		
12,4/11 x 24	●	●			14,9/13 x 30		●	●	●
13,6/12 x 24	●	●			16,9/14 x 30		●	●	●
14,9/13 x 24	●	●			18,4/15 x 30			●	●
16,9/14 x 24	●	●			12,4/11 x 32	●	●		
18,4/15 x 26		●	●	●	16,9/14 x 34			●	●
23,18 x 26		●	●	●	18,4/15 x 34			●	●
11,2/10 x 28	●	●			12,4/11 x 36		●	●	
12,4/11 x 28	●	●			23,1/ x 34			●	●
13,6/12 x 28	●	●			13,6/12 x 38		●	●	

*Za ostale dimenzije guma izrađuju se lanci po narudžbini.
*For all other tire sizes, chains can be made upon request.

LANAC ZK-K

CHAIN ZK-K

Dimenzijski program / Dimensions

17,50 - 25	18,4/15 - 30
18,4/15 - 26	16,9/14 - 30
23,1 - 28	16,9/14 - 34
23,1/18 - 26	18,4/15 - 34
	16,9/14 - 38



SASTAVLJENI VUČNI KOMPLET
INTEGRATED PULLING SET

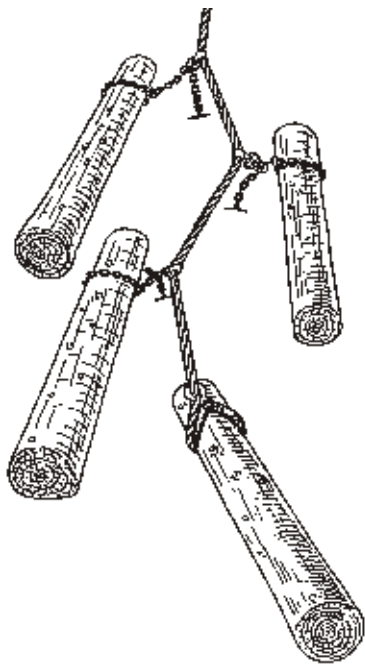

VUČNI LANAC
PULLING CHAIN



VUČNO UŽE
PULLING ROPE



VUČNI LANAC
PULLING CHAIN



OKRETNNA SPONA
ROTARY CONNECTION

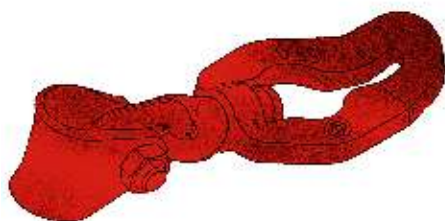

LANČANA KUKA
CHAIN HOOK



LANAC GRANIT
CHAIN GRANIT

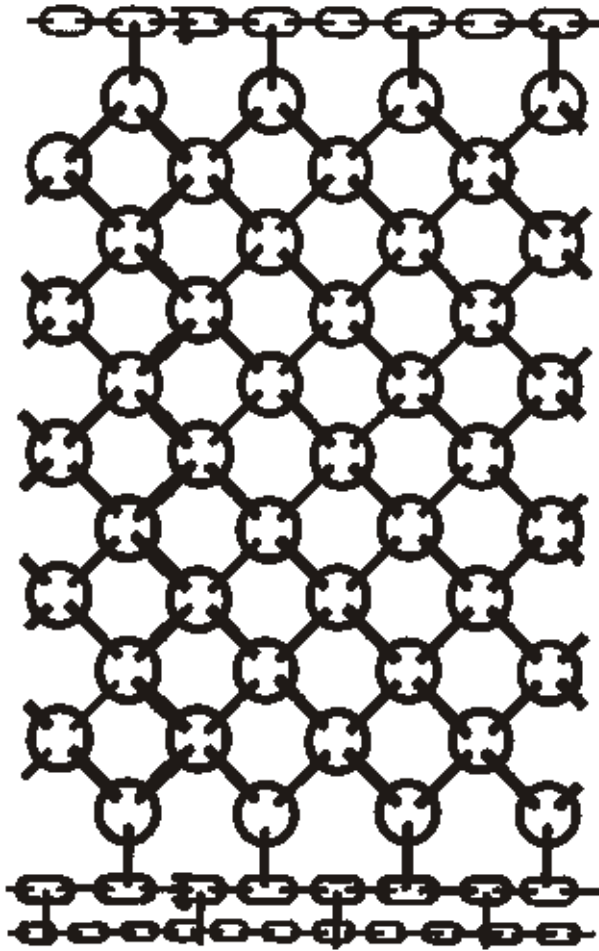

debljina lanca size of the connecting link	snaga mašina engine power	dimenzija gume tire size
Ø 9	up to 50 KW	10,00 - 20
Ø 11	30 - 80 KW	14,00 - 24
Ø 14	50 - 180 KW	20,5 - 25
Ø 16	80 - 250 KW	23,5 - 25



LANAC GX
CHAIN GX

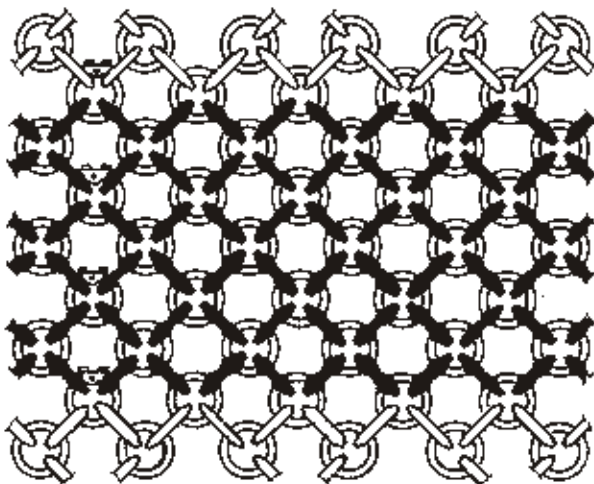

debljina lanca size of ring	snaga mašina engine power	dimenzija gume tire size	A	B	C
Ø 10	up to 100 KW	up to 14,00 - 24	60	30	22
Ø 13	50 - 150 KW	up to 26,5 - 25	74	38	28
Ø 16	80 - 150 KW	up to 35/65 - 33	87	48	34

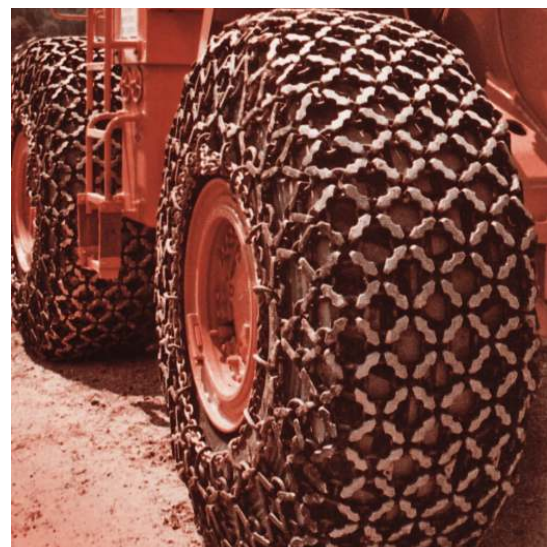

LANAC GN

CHAIN GN

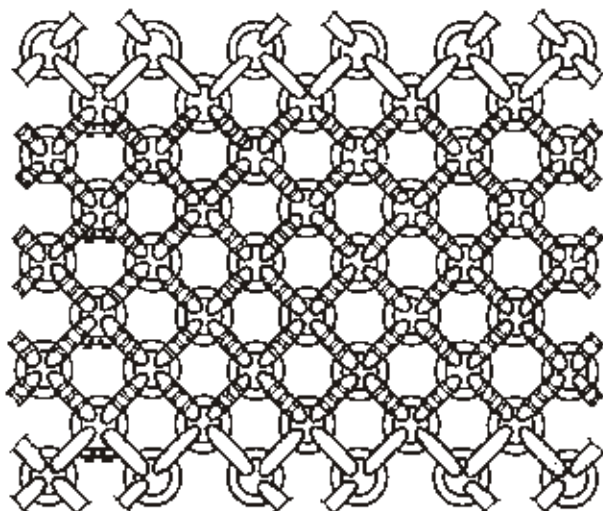

debljina lanca size of ring	snaga mašina engine power	dimenzija gume tire size	A	B	C
Ø 13	50 - 150 KW	up to 26,5 - 25	75	45	24
Ø 16	80 - 250 KW	up to 35/65 - 33	88	56	29
Ø 18	180 -350 KW	up to 45/65 - 45	96	63	32
Ø 20	more than 250 KW	up to 50/65 - 51L5	100	67	35
Ø 23	more then 250 KW		114	75	40

